

**13**

**INVESTMENT AREA NEXT TO  
NATIONAL ROAD 81**

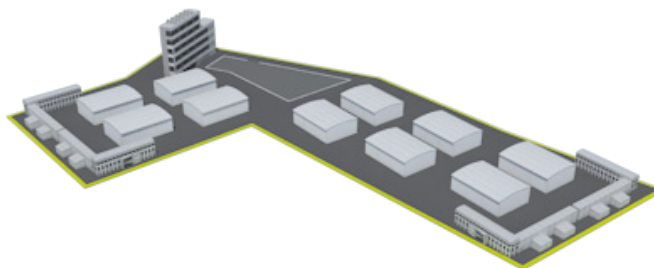

<b>Area number</b>		423/32, 422/32, 421/32, 420/32, 983/32, 982/32, 981/32, 403/39, 1030/40, 1031/40
<b>Localization</b>	<b>Localization</b>	Droga Krajowa 81, ul. Familijna
	<b>City / Municipality</b>	Żory
	<b>District</b>	Żory
	<b>Voivodeship</b>	Śląskie
<b>Terrain area</b>	<b>Area [ha]</b>	30,4041 ha
	<b>Area shape</b>	other shape
	<b>Possibility of terrain expansion</b>	YES - possibility of further negotiations with the private owners
<b>Terrain information</b>	<b>Owner / owners</b>	Private owners
	<b>Current plan of spatial development (Y/N)</b>	YES
	<b>Allocation on the local development plan</b>	Production - storage
<b>Terrain characteristic</b>	<b>Area classification</b>	R/RIIb – 11,8442 ha R/RIIIa – 14,4258 ha Br/RIIIa – 0,0342 ha S/RIIIa – 1,0314 ha Ps/PSIII – 0,7548 ha Br/RIIb – 0,2835 ha dr – 0,0737 ha R/RIVb – 1,2818 ha R/RIVa – 0,6747 ha the status of the land has been changed from agricultural to residential.
	<b>The current usage</b>	Agriculture
	<b>Pollution of surface and ground waters (Y/N)</b>	NO
	<b>Risk of flooding or land slides (Y/N)</b>	NO
	<b>Underground obstacles (Y/N)</b>	NO
	<b>Obstacles on the area (Y/N)</b>	YES
	<b>Existing ecological restrictions (Y/N)</b>	NO
	<b>Buildings on the area (Y/N)</b>	YES

Transport links	Access road to the site	Local road width around 3.5 m
	Highway / national road [km]	A1 Motorway – 7.5 km National Road 81 – 0.3 km
	Sea and river ports at a distance of up to 200 km	River port in Gliwice – 35 km
	Railway [km]	Rybnik – passenger and freight traffic – in distance of 14 km
	Railway siding [km]	Żory, ul. Wygoda – 6,5 km
	Nearest international airport [km]	Katowice - Pyrzowice – 65 km Kraków - Balice – 100 km
	Nearest voivodship city [km]	Katowice – 40 km
Existing infrastructure	Electricity on the area (Y/N)	YES
	Gas on the area (Y/N)	YES
	Water on the area (Y/N)	YES
	Sewage on the area (Y/N)	NO
	Distance of the connection from the border area	35 m
	A sewage treatment plant on area or in the immediate vicinity	NO
	Telephones (Y/N)	YES

## Contact regarding the investment

Department of Strategy and Development  
Al. Wojska Polskiego 25  
44-240 Żory  
tel: 32 43 48 234  
fax: 32 43 51 215  
e-mail: [sir@um.zory.pl](mailto:sir@um.zory.pl)

## Contact

City Hall  
Al. Wojska Polskiego 25  
44-240 Żory  
tel: 32 43 48 200  
fax: 32 43 51 215

ul. Rynek 9  
44-240 Żory  
tel: 32 43 48 100  
fax: 32 43 48 151



**REGIONAL PROGRAMME**  
NATIONAL COHESION STRATEGY



**EUROPEAN UNION**  
EUROPEAN REGIONAL  
DEVELOPMENT FUND



The project financed by the European Union from the European Regional Development Fund within the framework of the Regional Operational Program of the Silesia Voivodeship for the years 2007-2013.